

AF CB CP CS CV HD HS **R** SL WE XE XL

## SPECIFICATIONS (See notes 1 and 2)

**Loudspeaker Type:** 3-way, Horn-loaded tri-axial, weather resistant

**Operating Range:** 70 Hz - 16 kHz  
70 Hz - 10 kHz (+/-6dB)

**Max Input Ratings:** 400W continuous, 1000 W program  
40 volts RMS, 89 volts momentary peak

**Recommended Power Amplifier:**  
830W to 1200W @ 4 Ohms

**Sensitivity 1W/1m:**  
104 dB SPL (80 Hz - 16 kHz 1/3 octave bands)  
105 dB SPL (250 Hz - 4 kHz speech range)

**Maximum Output:** 130 dB SPL / 137 dB SPL (peak)

**Nominal Impedance:** 4 Ohms

**Min Impedance:** 2.9 Ohms @ 240 Hz

**Nominal -6dB Beamwidth:**  
60 - 90° H (+9° / -18°, 1.25 kHz - 10 kHz)  
40° V (+16° / -3°, 1.25 kHz - 10 kHz)  
100° H x 100° V (400 Hz)

**Axial Q / Di:** 19.6 / 12.9 (1.25 kHz - 10 kHz)

**Crossover Frequencies:** 600 Hz / 3.5 kHz

**Recommended Signal Processing:**  
70 Hz high pass filter

**Drivers:** LF (2) 12" weather-treated, Ferrofluid-cooled  
MF (1) M200 2" exit, non-metallic diaphragm,  
Ferrofluid-cooled  
HF (1) 1" exit, titanium diaphragm

**Driver Protection:** PowerSense™ DDP

**Input Connection:** 4 foot (1.2m) SJOW #16 Gauge

**Controls:** None

**Enclosure:** Hand-laminated fiberglass, gray gel-coat

**Mounting / Rigging Provisions:**  
(5) 1/2-13 rigging points

**Grille:** 3-layer Weather-Stop™,  
(Perforated steel, foam, stainless steel mesh)

**Required Accessories:**  
70 Hz high pass filter

**Supplied Accessories:**  
(5) 1/2-13 x 1" stainless steel bolts  
(5 ea.) Stainless steel lock, flat, and rubber washers

**Optional Accessories:**  
R2YOKE: mounting yoke kit  
DSC42: digital speaker controller  
TRC400: 400W 70/100/140 volt transformer  
R2BOX: rectangular Baltic Birch enclosure with handles

**Dimensions:**  
Height: 24.75 in. / 629 mm  
Width: 24.75 in. / 629 mm  
Depth: 29 in. / 737 mm

**Weight:** 78 lb. / 35.4 kg

**Shipping Weight:** 111 lb. / 50.3 kg

**1. Sensitivity:** Free field pink noise measurement at 40 ft / 12.2 m at 25% power; extrapolated to 1 meter and an input of 2 volts RMS.

**2. Watts:** All wattage figures are calculated using the rated nominal impedance.

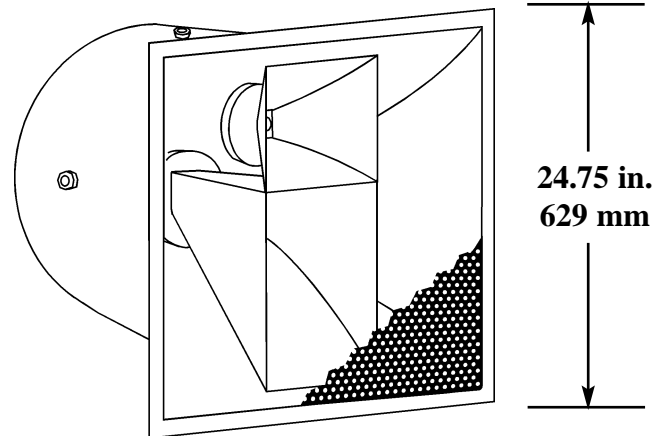

## APPLICATIONS:

- Athletic Fields, Small Arenas, Athletic Field Houses
- Theme and Amusement Parks
- Fairgrounds, Rodeos, Air Shows
- Racing Tracks, Skating Rinks, Swimming Pools
- Electronic Carillons
- Convention Centers, Ballrooms
- Cruise Ships
- Portable Sound Systems

## FEATURES:

- Weather Resistant Construction
- Application-Specific Coverage Pattern
- High Efficiency Horn Loading
- High-Fidelity, Full-Range Reproduction of Music And Speech
- Optional Yoke For Easy Mounting and Aiming

## DESCRIPTION

The R2-694 asymmetrical pattern full-range loudspeaker system is engineered to provide quality, full-range sound projection in a variety of outdoor and indoor applications. Its wide, smooth frequency response and high efficiency ensures high-fidelity music reproduction along with superb projection of clear, intelligible speech at very low distortion.

The R2-694 is an all horn-loaded tri-axial design using precision waveguides manufactured by Community of hand-laminated fiberglass. The outer enclosure forms a double wall construction with the internal bass horn, providing a completely weather-sealed chamber for the LF drivers. The mid/high frequency horn assembly is mounted in the mouth of the bass horn. A high quality passive crossover with dynamic driver protection is included. There is a mounting yoke available. The result is a loudspeaker system that is extremely strong, non-resonant, weather-resistant, and easy to install. Five year limited warranty.

AF CB CP CS CV HD HS **R** SL WE XE XL

### FREQUENCY RESPONSE

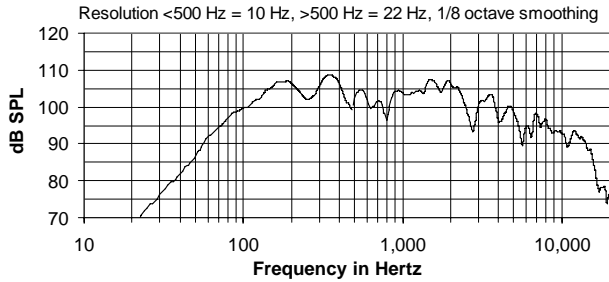

### IMPEDANCE

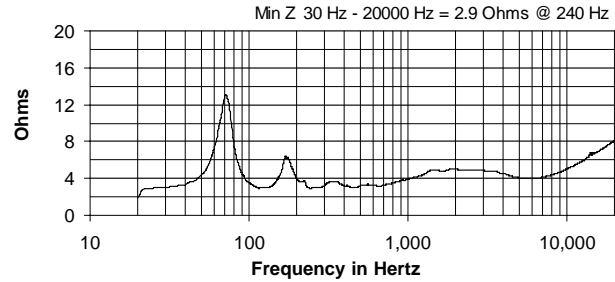

### BEAMWIDTH

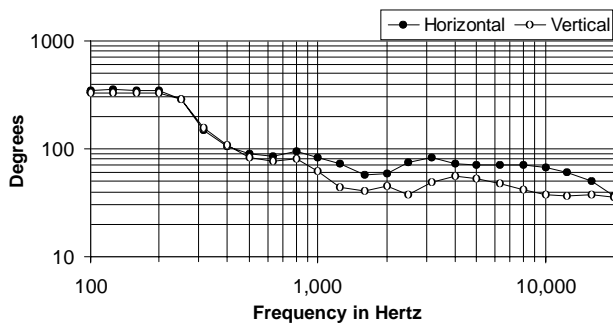

### AXIAL Q

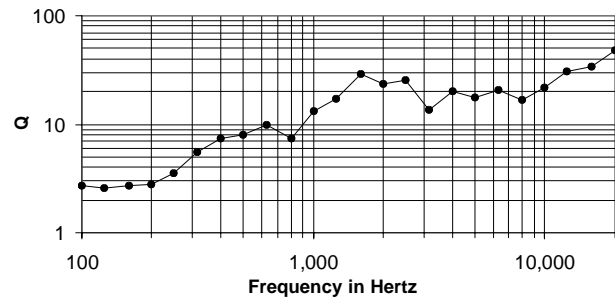

### DIMENSIONS

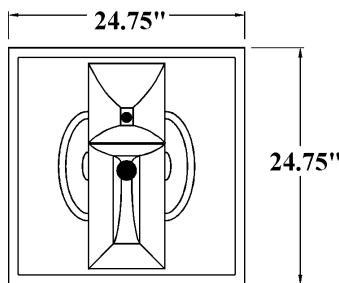

front view

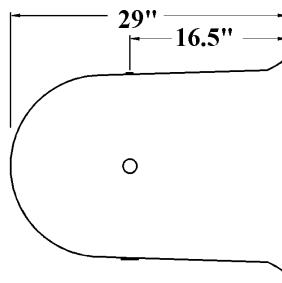

side view

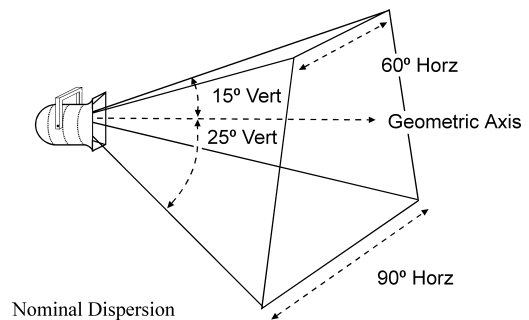

Nominal Dispersion

### ARCHITECTS' AND ENGINEERS' SPECIFICATIONS

The loudspeaker system shall be a horn-loaded, three-way, full-range tri-axial design with two 12" Ferrofluid-cooled woofers treated with moisture repellant on a bass horn and one 2" exit Ferrofluid-cooled midrange compression driver with a non-metallic diaphragm and one 1" exit HF driver with a titanium diaphragm mounted on respective fiberglass horns built within the bass horn. Drivers shall be connected to an integral crossover with crossover frequencies of 600 Hz and 3.5 kHz and integral over-current protection circuitry using high positive current coefficient resistors. The input connection shall be one 4' x 16-2 SJOW Cable with stripped ends. The loudspeaker enclosure shall be an integral double-wall weather-sealed gray fiberglass bell with a 16 gauge perforated steel grille backed by open cell foam and a 100 x 100 wire sq. in. stainless steel mesh. There shall be five 1/2 - 13 threaded mounting points. The system shall have an amplitude response of 70 Hz to 10 kHz (+/- 6 dB), input capability of 40V RMS, 104 dB sensitivity at one meter / 2 V and 4 ohms nominal impedance. The nominal dispersion shall be 60° - 90°H x 40°V from 1250 Hz to 10 kHz. The loudspeaker shall be 24.75 in. (629 mm) H x 24.75 in. (629 mm) W x 29 in. (737 mm) D and weigh 78 lbs. (35.4 kg).

Specifications subject to change without notice.

R2-694 Page 2 of 2