



Shure Brothers Incorporated
222 Hartrey Avenue
Evanston IL 60202-3696 U.S.A.

Phone: 800-257-4873 Fax: 847-866-2279
In Europe, Phone: 49-7131-72140 Fax: 49-7131-721414
Internationally, Phone: 847-866-2200 Fax: 847-866-2585
Web Address: <http://www.shure.com>

P6HW HARDWIRED PERSONAL STEREO MONITOR

Specification Sheet

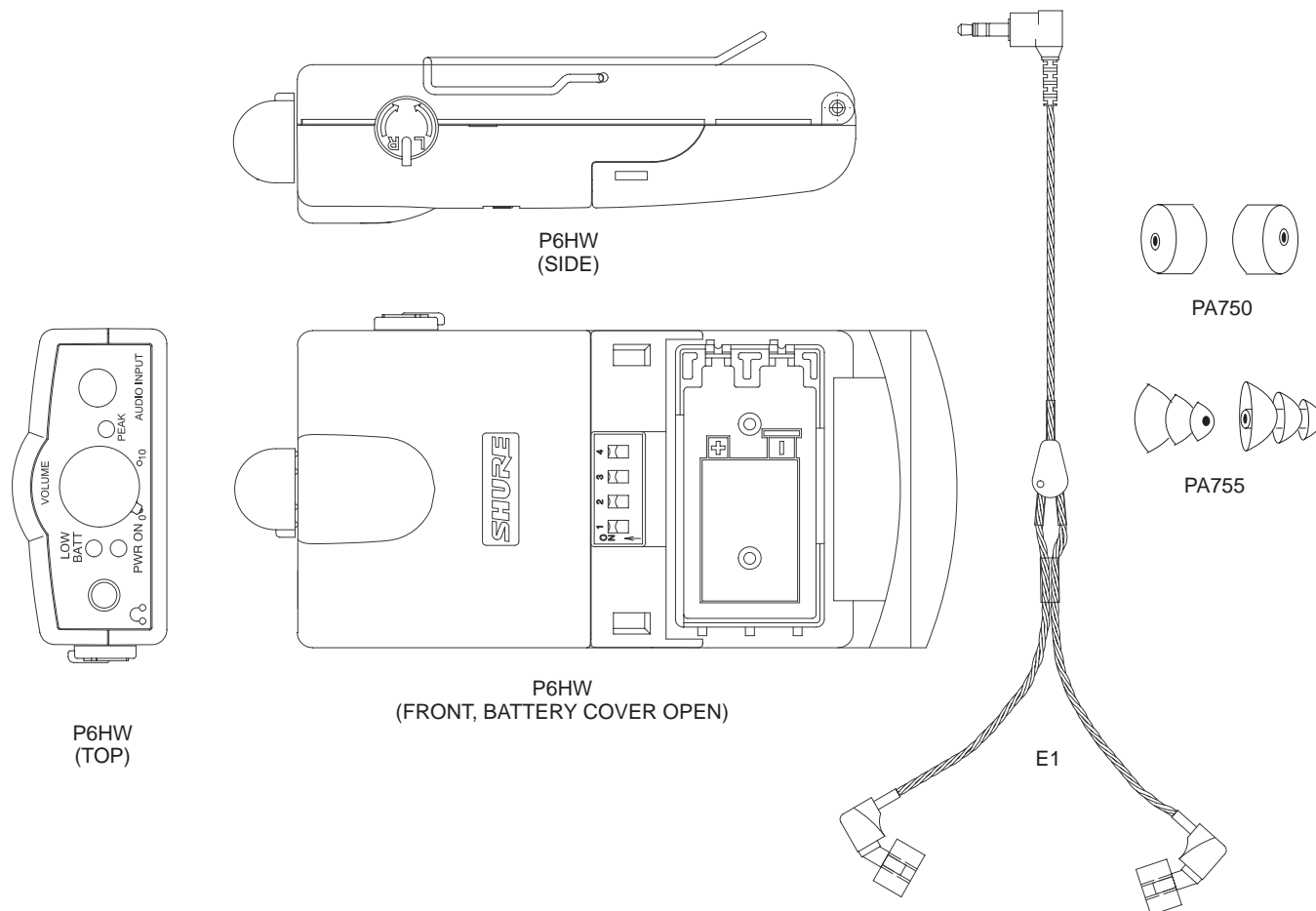

SHURE PSM600 MODEL P6HW AND MODEL E1

The Shure P6HW hardwired Personal Stereo Monitor is a two-channel system designed for onstage monitoring. The P6HW has several advantages over onstage monitor loudspeakers: it is less visible, offers improved clarity and control of sound, and reduces the chances of feedback. This portable, lightweight unit also allows freedom of movement while reducing stage clutter. It is a versatile system, designed for use in many different sound reinforcement applications: public address, live music, studio recording, broadcast, and theater.

The superior sounding Shure E1 Personal Stereo Monitor Earpieces are designed to connect to the P6R and P6HW bodypacks for the Shure Personal Stereo Monitor Systems.

P6HW Features

- Peak limiter with fixed threshold, DIP switch defeat-able
- Stereo or MixMode™ control for custom monitor mixes
- Easily accessible volume and balance controls
- Shelving, high frequency boost switch
- Input Clip indicator
- 15 dB input pad switch

E1 Features

- Small size for comfort and low visibility
- Extra foam ear inserts included
- Optional custom-fit upgrades for improved isolation and sound quality

APPLICATION

The monitor (AUX) outputs of the mixer are connected to the P6HW body pack using the supplied Dual-XLR-to-LEMO Y-cable. Then, the earpiece is connected to the Output Connector of the P6HW.

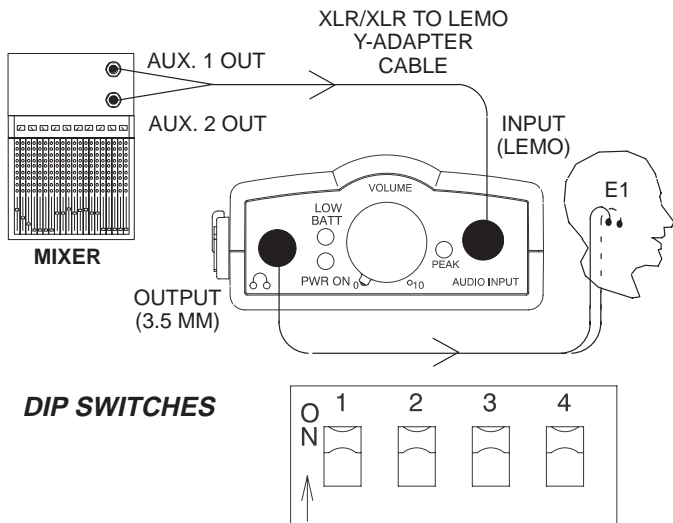

| DIP SWITCH | FUNCTION | UP | DOWN |
|------------|--------------------------------|--|-----------------|
| 1 | 15 dB left/right input pad | Attenuates left/right channel input signal. | OFF |
| 2 | Stereo/MixMode™ | MixMode | stereo mode |
| 3 | Equalization (Flat/High Boost) | Gives a 6 dB boost above 5 kHz for a greater high-end response | normal response |
| 4 | Limiter defeat | Limiter ON | Limiter OFF |

P6HW SPECIFICATIONS

Frequency Response

20 Hz to 20 KHz

Total Harmonic Distortion*

0.18% for $R_L = 18 \Omega$

0.08% for $R_L = 63 \Omega$

Channel Separation*

40 dB (minimum)

Maximum Input Level*

+2 dBu (Clip LED intermittent)

+7 dBu (Clip LED on)

Signal-to-Noise Ratio*

85 dB (minimum)

Output Level*

+4.5 dBu (1% THD, $R_L = 18 \Omega$)

Minimum Load Impedance*

16 Ω

Power Requirements

9 V battery

Battery Life

10 to 12 hours (volume dependent)

Connectors

Output: 3.5 mm, stereo (Tip=left, Ring=right, Sleeve=ground)

Input: LEMO, 5-pin (pin 1 indicated by red dot), phantom power protected.

Dimensions

111 mm (4.4 in.) x 64.5 mm (2.5 in.) x 31.9 mm (1.2 in.)

Net Weight: 209.8 g (7.4 oz)

Certification

Conforms to European Union directives, eligible to bear CE marking; meets European Union EMC Immunity Requirements (EN 50 082-1, 1992): RF radiated (IEC 801-3): meets Criterion A; ESD (IEC 801-2): meets Criterion B; EFT (IEC 801-4): meets Criterion B.

Accessories

XLR Male to 1/4-in. Connector Balanced Cable . . . PA730

Furnished Accessory

Dual XLR Female to LEMO Input Y-Cable PA720

E1 SPECIFICATIONS

Transducer Type

Balanced Armature

Sensitivity*

113 dB SPL/mW

Impedance*

24 Ω

Connector

Gold-plated, stereo, 3.5 mm (1/8-in.) plug

Cable Length

1.5 m (60 in)

Net Weight: 17 g (.625 oz)

Furnished Accessory

Foam Ear Inserts (10) PA750

Optional Accessories

Triple-Flange Ear Inserts (2) PA755

For additional service or parts information, please contact Shure's Service department at 1-800-516-2525. Outside the United States, please contact your authorized Shure Service Center.